

- NOTES:**
- DO NOT SCALE FROM THIS DRAWING.
 - ALL DIMENSIONS ARE IN METRES UNLESS OTHERWISE STATED.
 - ANY WORK OUTSIDE THE HIGHWAY BOUNDARY NEEDS PRIOR PERMISSION FROM THE LAND OWNER. THIS LAYOUT SHALL NOT BE USED FOR CONSTRUCTION.
 - HEALTH AND SAFETY: THE CONTRACTOR SHALL BE AWARE OF ALL THE STATUTORY UNDERTAKERS PLANT THAT MAY BE LOCATED WITHIN THE PLANS SHOWING APPROXIMATE LOCATIONS WHICH HAVE BEEN SUPPLIED BY THE ASSET OWNER.
 - LIMIT OF WORK SHOWN ON DRAWING ARE INDICATIVE ONLY.
 - PROPOSED TRAFFIC SIGNS AND ROAD MARKINGS TYPES / COLOURS & DIMENSIONS SHALL BE IN ACCORDANCE WITH TSRGD 2016 AND SUBSEQUENT AMENDMENTS.
 - AT TIE-IN LOCATIONS, UPSTAND OF THE EXISTING KERB TO BE CONFIRMED AT SITE AND SUITABLE TRANSITION KERB TO BE PROVIDED.
 - EXISTING CANOPY TO BE TRIMMED UPTO 5.5m HEIGHT OVER CARRIAGEWAY & 2.5m HEIGHT OVER FOOTWAY AND VERGE PRIOR TO WORK WITH APPROVAL VIA THE OVERSEEING ORGANISATION.

- KEY:**
- EXISTING HIGHWAY BOUNDARY
 - PROPOSED DROPPED KERB (BN3) (75mm UPSTAND)
 - PROPOSED TRANSITION KERB (BETWEEN EXISTING AND BN3)
 - PROPOSED FLAT TOPPED EDGING
 - PROPOSED ROAD MARKINGS (WHITE)
 - PROPOSED FOOTWAY
 - PROPOSED BLISTER TACTILE PAVING (RED COLOUR)
 - PROPOSED RAISED TABLE / FLAT TOP HUMPS
 - EXISTING FOOTWAY
 - EXISTING FOOTWAY TO BE RESURFACED
 - PROPOSED HIGH FRICTION SURFACE (PSV 60+)
 - PROPOSED RAMP
 - PROPOSED TRAFFIC SIGN & POST
 - PROPOSED GULLY
 - SITE EXTENT

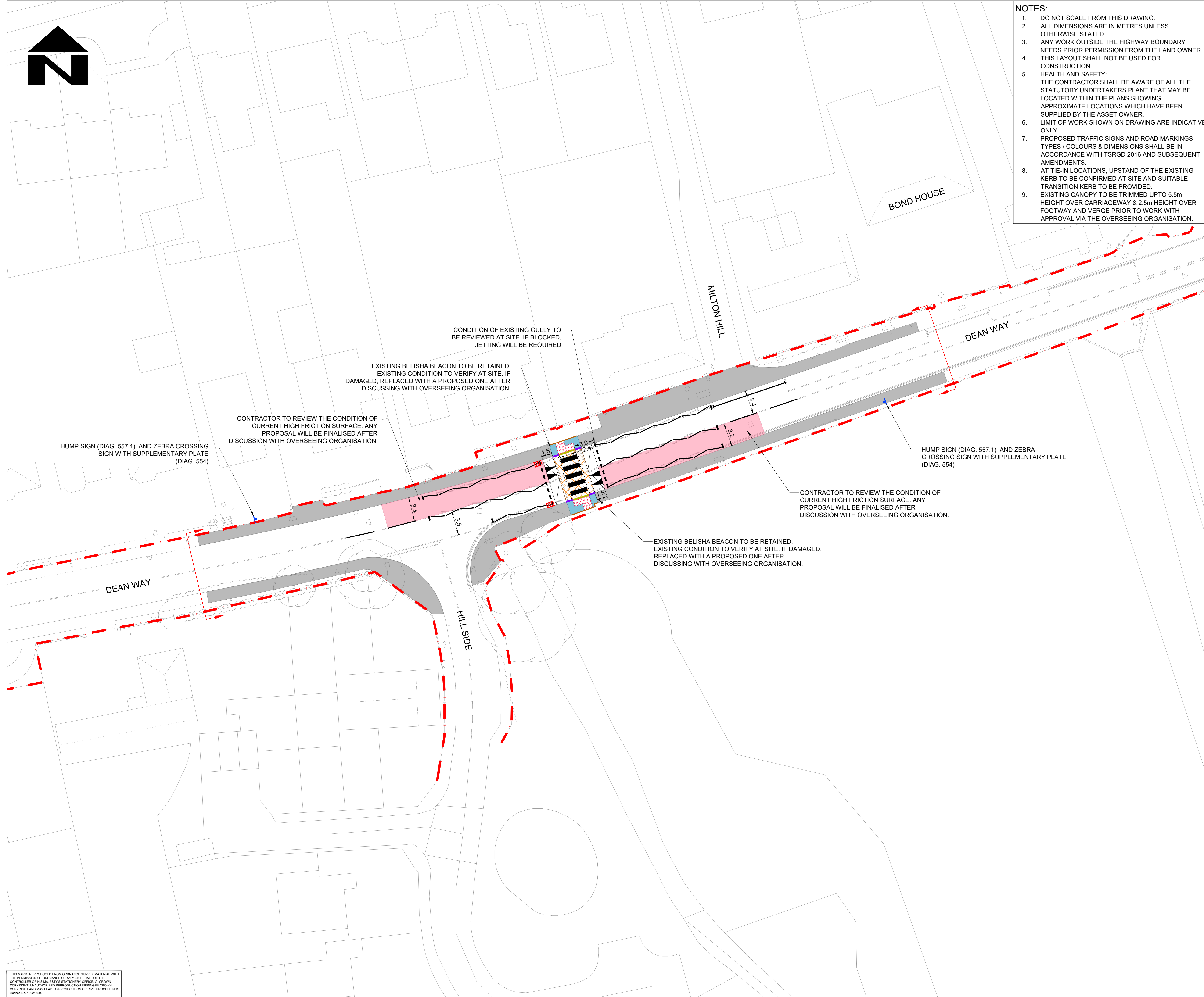

SAFETY, HEALTH AND ENVIRONMENTAL INFORMATION

In addition to the hazards/risks normally associated with the types of work detailed on this drawing, note the following significant residual risks (Reference shall also be made to the design hazard log).

Construction
Live traffic & utilities.
Presence of tar, presence of soil contamination, asbestos and breaking of concrete not known.

Maintenance / Cleaning
None

Use
None

Decommissioning / Demolition
None

P01	YB	KM	PK	20/10/23
First Issue				
P02	PG	KM	PK	09/11/23
Comments Incorporated				
Rev	Drawn / Des	Checked	Approved	Date
Description				

Drawing Status				Suitability
FOR REVIEW / COMMENT				S3

Copyright © AtkinsRéalis Limited (2023)

Client

AtkinsRéalis
Walton Street Office,
Walton Street
Aylesbury
Buckinghamshire
HP20 1UA GB
www.atkinsglobal.com

Buckinghamshire Highways
Kevin Good
Service Director
Highways & Technical Services

Project Title
5223781 Detailed Design of RSF Schemes Tranche 2 refs-41b-55-58

Drawing Title
PRELIMINARY LAYOUT PLAN SCHEME 58B - DEANWAY RAISED TABLE WITH ZEBRA CROSSING

Scale	Designed / Drawn	Checked	Approved	Authorised
1:250	PG	KM	PK	---
Original Size	Date	Date	Date	Date
A1	09/11/23	09/11/23	09/11/23	---
Drawing Number	Project	Originator	Volume	Job No.
5223781	5223781	ATK	HGN	5223781
S4	S4	DR - CH	- 000001	P02
Location	Type	Role	Number	Revision

THIS MAP IS REPRODUCED FROM ORDNANCE SURVEY MATERIAL WITH THE PERMISSION OF ORDNANCE SURVEY ON BEHALF OF THE CONTROLLER OF HIS MAJESTY'S STATIONERY OFFICE. © CROWN COPYRIGHT. UNAUTHORISED REPRODUCTION INFRINGES CROWN COPYRIGHT AND MAY LEAD TO PROSECUTION OR CIVIL PROCEEDINGS. License No. 10021029