

HIGH STREET

BAKER STREET

CHESTNUT CLOSE

BAKER STREET

KEY:

- EXISTING HIGHWAY BOUNDARY (INDICATIVE)
- PROPOSED TRAFFIC SIGN FACE/POST
- PROPOSED ROAD MARKINGS
- EXISTING ROAD MARKINGS TO BE RETAINED
- EXISTING ROAD MARKINGS TO BE REMOVED
- EXISTING LIGHTING COLUMN
- SITE EXTENT

NOTES:

1. DO NOT SCALE FROM THIS DRAWING.
2. ALL DIMENSIONS ARE IN METRES UNLESS OTHERWISE STATED.
3. THIS LAYOUT IS FOR CONSULTATION ONLY AND SHALL NOT BE USED FOR CONSTRUCTION.

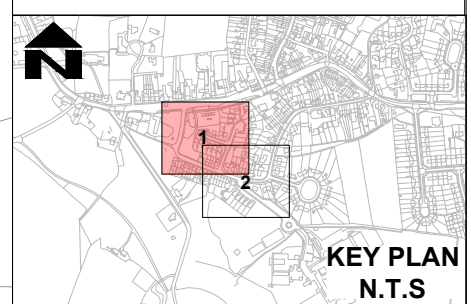

PROPOSED DOUBLE YELLOW LINE(1018.1) (APPROX. 109m)

PROPOSED DOUBLE YELLOW LINE (1018.1) (APPROX. 15m)



NEW SIGN FACE TO BE INSTALLED ON EXISTING LIGHTING COLUMN, MOUNTING HEIGHT OF 2.1m

PROPOSED SINGLE YELLOW LINE (1017) (APPROX. 34m)



PROPOSED SIGN FACE TO MOUNT ON NEW POST AND FOUNDATION, MOUNTING HEIGHT OF 2.1m

SAFETY, HEALTH AND ENVIRONMENTAL INFORMATION

In addition to the hazards/risks normally associated with the types of work detailed on this drawing, note the following significant residual risks (Reference shall also be made to the design hazard log).

Construction	None
Maintenance / Cleaning	None
Use	None
Decommissioning / Demolition	None

P01	SV	KM	NS	15/01/26
Issued for consultation				
P02		SG	MR	18/05/26
For Public Consultation				
P03		SG	MR	03/06/26
For Public Consultation				
Rev	Drawn / Des	Checked	Approved	Date
Description				

Drawing Status	FOR INFORMATION	Suitability	S2
----------------	-----------------	-------------	----

AtkinsRéalis
 Walton Street Office,
 Walton Street
 Aylesbury
 Buckinghamshire
 HP20 1UA GB
 www.atkinsrealis.com

Copyright © AtkinsRéalis Limited (2026)

Buckinghamshire Highways
 Kevin Goad
 Service Director
 Highways & Technical Services

Project Title
HS2 Road Safety Fund Tranche 3 Assessment

Drawing Title
CONSULTATION PLAN BAKER STREET, WADDES DON PARKING RESTRICTIONS (SHEET 1 OF 2)

Scale	1:500	Designed / Drawn	Checked	Approved	Authorised
Original Size	A3	Date	Date	Date	Date
Drawing Number	10009888	Project	Originator	Volume	Job No.
	RS26	10009888	ATR	HGN	10009888
			- SK - CH - 000001		P03
			Location	Type	Role

THIS MAP IS REPRODUCED FROM ORDNANCE SURVEY MATERIAL WITH THE PERMISSION OF ORDNANCE SURVEY ON BEHALF OF THE CONTROLLER OF HER MAJESTY'S STATIONERY OFFICE. © CROWN COPYRIGHT. UNAUTHORISED REPRODUCTION INFRINGES CROWN COPYRIGHT AND MAY LEAD TO PROSECUTION OR CIVIL PROCEEDINGS. License No. 010002456

FOR CONTINUATION SEE DRAWING NO. 10009888-ATR-HGN-RS26-SK-CH-000002

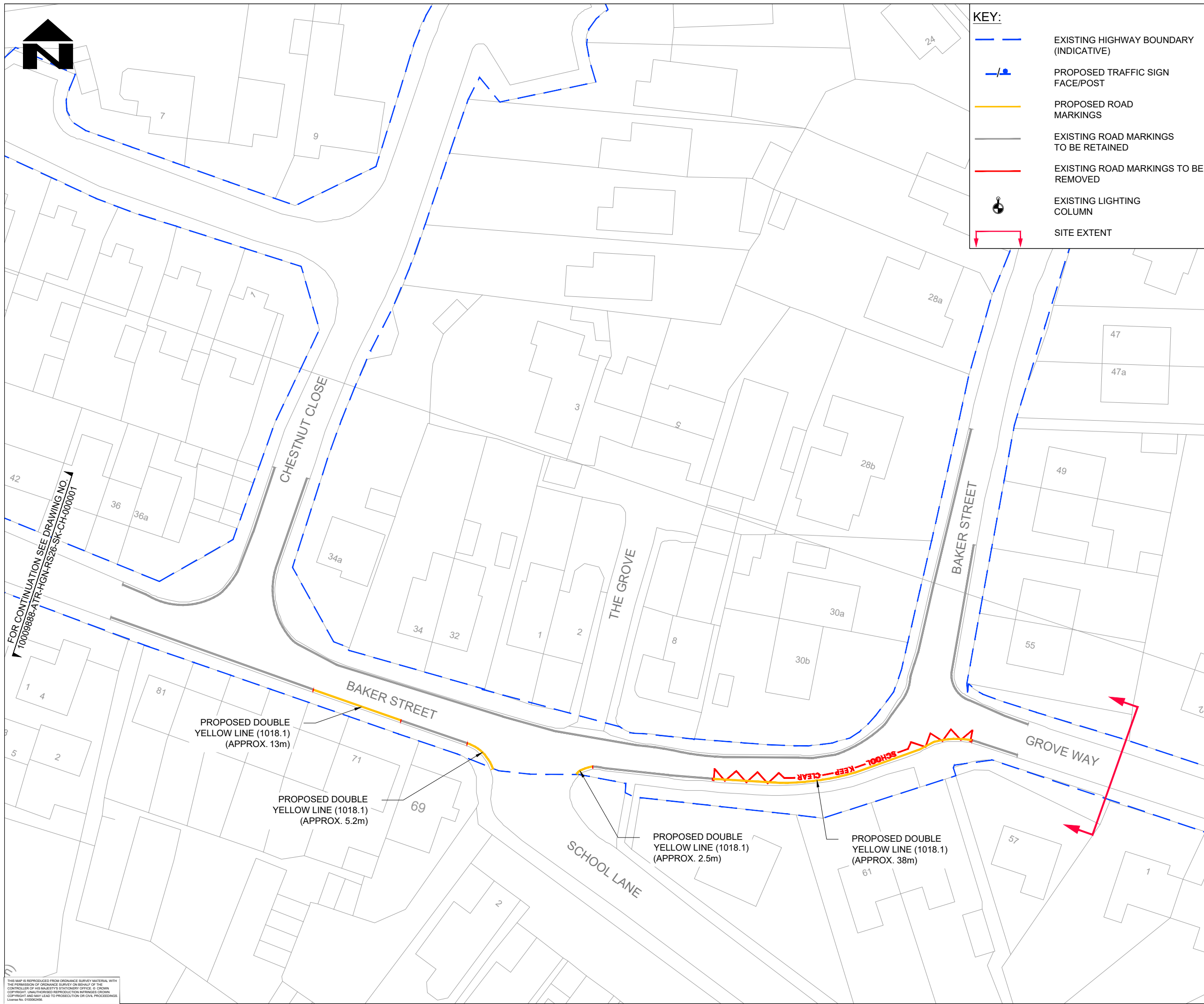

KEY:

- EXISTING HIGHWAY BOUNDARY (INDICATIVE)
- PROPOSED TRAFFIC SIGN FACE/POST
- PROPOSED ROAD MARKINGS
- EXISTING ROAD MARKINGS TO BE RETAINED
- EXISTING ROAD MARKINGS TO BE REMOVED
- EXISTING LIGHTING COLUMN
- SITE EXTENT

- NOTES:**
- DO NOT SCALE FROM THIS DRAWING.
 - ALL DIMENSIONS ARE IN METRES UNLESS OTHERWISE STATED.
 - THIS LAYOUT IS FOR CONSULTATION ONLY AND SHALL NOT BE USED FOR CONSTRUCTION.

NOT FOR CONSTRUCTION

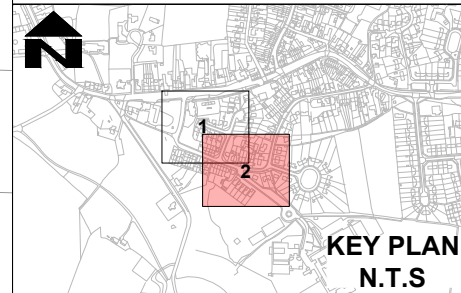

SAFETY, HEALTH AND ENVIRONMENTAL INFORMATION

In addition to the hazards/risks normally associated with the types of work detailed on this drawing, note the following significant residual risks (Reference shall also be made to the design hazard log).

Construction				
None				
Maintenance / Cleaning				
None				
Use				
None				
Decommissioning / Demolition				
None				
P01	SV	KM	NS	15/01/26
Issued for consultation				
P02		SG	MR	18/05/26
For Public Consultation				
P03	AA	SG	MR	03/06/26
For Public Consultation				
P04		SG	MR	04/06/26
For Public Consultation				
Rev	Drawn / Des	Checked	Approved	Date

Description	
Drawing Status	Suitability
FOR INFORMATION	S2

AtkinsRéalis
 Walton Street Office,
 Walton Street
 Aylesbury
 Buckinghamshire
 HP20 1UA GB
 www.atkinsrealis.com

Copyright © AtkinsRéalis Limited (2026)

Client
 Kevin Goad
 Service Director
 Highways & Technical Services

Project Title
**HS2 Road Safety Fund
 Tranche 3 Assessment**

Drawing Title
**CONSULTATION PLAN
 BAKER STREET, WADDESDON PARKING
 RESTRICTIONS (SHEET 2 OF 2)**

Scale	Designed / Drawn	Checked	Approved	Authorised
1:500		SG	MR	TK
Original Size	Date	Date	Date	Date
A3	04/06/26	04/06/26	04/06/26	04/06/26
Drawing Number	Project	Originator	Volume	Job No.
10009888	RS26	ATR	SK - CH - 000002	10009888
	Location	Type	Role	Number
				P04

FOR CONTINUATION SEE DRAWING NO
 10009888-ATR-HGN-RS26-SK-CH-000002

THIS MAP IS REPRODUCED FROM ORDNANCE SURVEY MATERIAL WITH THE PERMISSION OF ORDNANCE SURVEY ON BEHALF OF THE CONTROLLER OF HER MAJESTY'S STATIONERY OFFICE. © CROWN COPYRIGHT. UNAUTHORISED REPRODUCTION INFRINGES CROWN COPYRIGHT AND MAY LEAD TO PROSECUTION OR CIVIL PROCEEDINGS. Licence No: 010002456