

KEY:

- EXISTING HIGHWAY BOUNDARY
- EXISTING TRAFFIC SIGN FACES/POSTS
- PROPOSED TRAFFIC SIGN FACES/POSTS
- RELOCATED TRAFFIC SIGNS
- PROPOSED KERBLINE
- PROPOSED EDGING KERB
- PROPOSED ROAD MARKINGS
- EXISTING ROAD MARKINGS TO BE REMOVED
- EXISTING ROAD MARKINGS TO BE RETAINED
- EXISTING GREEN SPACE
- EXISTING CARRIAGEWAY
- EXISTING FOOTWAY
- EXISTING SHARED USE FACILITY
- PROPOSED SHARED USE FACILITY (TARMAC)
- PROPOSED BLISTER TACTILE PAVING (RED COLOUR)
- PROPOSED BLISTER TACTILE PAVING (BUFF COLOUR)
- PROPOSED CORDUROY PAVING
- INDICATIVE LOCATION FOR TRAFFIC SIGNAL
- PROPOSED BOLLARD
- EXISTING LIGHTING COLUMN TO BE RETAINED
- SITE EXTENT

- NOTES:**
- DO NOT SCALE FROM THIS DRAWING.
 - ALL DIMENSIONS ARE IN METRES UNLESS OTHERWISE STATED.
 - THIS LAYOUT IS FOR CONSULTATION ONLY AND SHALL NOT BE USED FOR CONSTRUCTION.

NOT FOR CONSTRUCTION

SAFETY, HEALTH AND ENVIRONMENTAL INFORMATION

In addition to the hazards/risks normally associated with the types of work detailed on this drawing, note the following significant residual risks (Reference shall also be made to the design hazard log).

Construction	None
Maintenance / Cleaning	None
Use	None
Decommissioning / Demolition	None

P01	PG	SG	CC	12/11/25
For Consultation				
Rev	Drawn / Des	Checked	Approved	Date
Description				

Drawing Status	Suitability
FOR INFORMATION	S2

AtkinsRéalis
Walton Street Office,
Walton Street
Aylesbury
Buckinghamshire
HP20 1UA GB
www.atkinsglobal.com

Copyright © AtkinsRéalis Limited (2025)

Buckinghamshire Highways
Kevin Goad
Service Director
Highways & Technical Services

Project Title
Pinewood Road Toucan Crossing

Drawing Title
PROPOSED TOUCAN CROSSING CONSULTATION PLAN

Scale	1:500	Designed / Drawn	PG	Checked	SG	Approved	CC	Authorised	VK
Original Size	A3	Date	11/11/25	Date	11/11/25	Date	12/11/25	Date	12/11/25
Drawing Number	00122954	Project	ATR	Volume	HGN	Location	XX	Job No.	00122954
			- SK		- CH		- 000002	Revision	P01

THIS MAP IS REPRODUCED FROM ORDNANCE SURVEY MATERIAL WITH THE PERMISSION OF ORDNANCE SURVEY ON BEHALF OF THE CONTROLLER OF HIS MAJESTY'S STATIONERY OFFICE. © CROWN COPYRIGHT. UNAUTHORISED REPRODUCTION INFRINGES CROWN COPYRIGHT AND MAY LEAD TO PROSECUTION OR CIVIL PROCEEDINGS. Licence No. 010002456

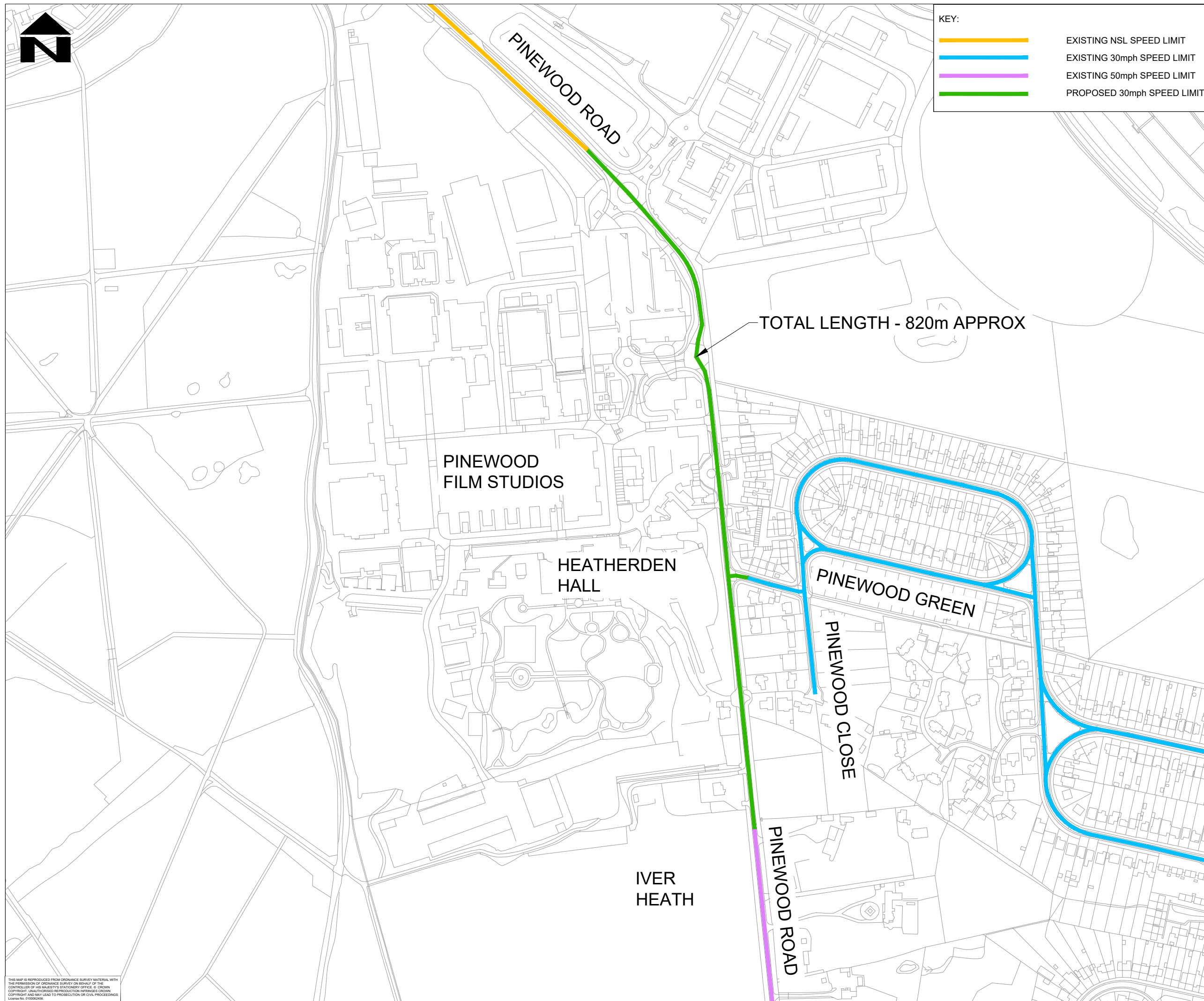

KEY:

- EXISTING NSL SPEED LIMIT
- EXISTING 30mph SPEED LIMIT
- EXISTING 50mph SPEED LIMIT
- PROPOSED 30mph SPEED LIMIT

NOTES:

1. DO NOT SCALE FROM THIS DRAWING.
2. ALL DIMENSIONS ARE IN METRES UNLESS OTHERWISE STATED.
3. THE PLAN DO NOT SHOW THE LOCATION OF PROPOSED REPEATER SIGNS.
4. THIS LAYOUT IS FOR CONSULTATION ONLY AND SHALL NOT BE USED FOR CONSTRUCTION.

NOT FOR CONSTRUCTION

SAFETY, HEALTH AND ENVIRONMENTAL INFORMATION

In addition to the hazards/risks normally associated with the types of work detailed on this drawing, note the following significant residual risks (Reference shall also be made to the design hazard log).

Construction	None
Maintenance / Cleaning	None
Use	None
Decommissioning / Demolition	None

P01.3	PG	SG	---	---
-------	----	----	-----	-----

For Consultation

Rev	Drawn / Des	Checked	Approved	Date
Description				

Drawing Status	FOR INFORMATION	Suitability	S2
----------------	-----------------	-------------	----

AtkinsRéalis
 Walton Street Office,
 Walton Street
 Aylesbury
 Buckinghamshire
 HP20 1UA GB
 www.atkinsglobal.com

Copyright © AtkinsRéalis Limited (2025)

Buckinghamshire Highways
 Kevin Goad
 Service Director
 Highways & Technical Services

Project Title
Pinewood Road Toucan Crossing

SPEED LIMIT CONSULTATION PLAN

Scale	Designed / Drawn	Checked	Approved	Authorised
NTS	PG	SG	---	---
Original Size	Date	Date	Date	Date
A3	11/11/25	11/11/25	---	---
Drawing Number	Project	Originator	Volume	Job No.
00122954	00122954	ATR	HGN	00122954
XX	- SK - CH - 000001	-	-	P01.3
Location	Type	Role	Number	Revision

THIS MAP IS REPRODUCED FROM ORDNANCE SURVEY MATERIAL WITH THE PERMISSION OF ORDNANCE SURVEY ON BEHALF OF THE CONTROLLER OF HIS MAJESTY'S STATIONERY OFFICE. © CROWN COPYRIGHT. UNAUTHORISED REPRODUCTION INFRINGES CROWN COPYRIGHT AND MAY LEAD TO PROSECUTION OR CIVIL PROCEEDINGS. License No. 010002456.