

- NOTES:**
- DO NOT SCALE FROM THIS DRAWING.
  - ALL DIMENSIONS ARE IN METRES UNLESS STATED.
  - TOTAL AREAS ARE NOTES IN KEY.
  - THERE IS NO TOPOGRAPHICAL DATA FOR THIS SCHEME. ALL INFORMATION IS BASED ON OS DATA AS WELL AS THE WTB SURVEY CARRIED OUT NOVEMBER 2023.
  - ALL WORKS ARE TO BE CARRIED OUT AND CONSTRUCTED AS PER BUCKINGHAMSHIRE COUNCIL SPECIFICATIONS UNLESS STATED OTHERWISE
- KEY:**
- 20mm FOOTWAY REINSTATEMENT = 25m<sup>2</sup>
  - 70mm FOOTWAY REINSTATEMENT = 121m<sup>2</sup>
  - 170mm FOOTWAY FULL CONSTRUCTION = 70m<sup>2</sup>
  - BREAK UP ASPHALT AND TAKE TO TIP, TOPSOIL AND SEED = 14m<sup>2</sup>
  - 150mm TOPSOIL AND SEED = 115m<sup>2</sup>
  - FLEXIPAVE MATERIAL = 11m<sup>2</sup>
  - POSSIBLE FULL CARRIAGEWAY CONSTRUCTION = 65m<sup>2</sup> @550mm DEPTH
  - TREE AND ROOT SYSTEM REMOVAL
  - 150mm TOPSOIL = 7m<sup>2</sup>
  - 40mm THSC AND REGULATING COURSE = 151m<sup>2</sup>
  - RESET BLOCK WORK, 25mm SAND BED =62m<sup>2</sup>
  - KERB
  - EDGING KERB
  - TACTILE PAVING WITH 25mm SAND BED AND TYPE 1 SUB-BASE MATERIAL = 34m<sup>2</sup>
  - NEW STEEL BOLLARD
  - ADJUST AND RE-SEAT STEEL BOLLARD
  - LIGHTING COLUMN
  - HEDGE TRIM / VEG CLEARANCE
  - DROP KERB
  - ROOT PROTECTION AREA (RPA)
  - TREE CANOPY
  - TREE TO RETAIN
  - TREE TO REMOVE

**SAFETY, HEALTH AND ENVIRONMENTAL INFORMATION**

In addition to the hazards/risks normally associated with the types of work detailed on this drawing, note the following significant residual risks (Reference shall also be made to the design hazard log).

**Construction**  
Live traffic.  
Presence of tar, presence of soil contamination, asbestos and breaking of concrete not known.  
Underground services present throughout site works but unrecorded or unidentified utilities may still be present.

**Maintenance / Cleaning**  
None.

**Use**  
Low long-term risk of trees and roots potentially causing obstruction and/or damage to the footway and surrounding areas.

**Decommissioning / Demolition**  
None

					08/05/24
--	--	--	--	--	----------

P01	ZM	GC	GC	08/05/24
-----	----	----	----	----------

P02	ZM	PB	JH	03/07/24
-----	----	----	----	----------

Rev	Drawn / Des	Checked	Approved	Date
-----	-------------	---------	----------	------

Description

Drawing Status	FOR REVIEW / COMMENT	Suitability	S3
----------------	----------------------	-------------	----

**AtkinsRéalis**  
Walton Street Office,  
Walton Street  
Aylesbury  
Buckinghamshire  
HP20 1UA GB  
www.atkinsglobal.com

Copyright © AtkinsRéalis (2023)  
Client

**Buckinghamshire Highways**  
Kevin Good  
Service Director  
Highways & Technical Services

Project Title  
**5221621 Footway Structural Repairs Maintenance**

Drawing Title  
**BH23FW018 MAXWELL ROAD, BEACONSFIELD OPTION 3**

Scale	Designed / Drawn	Checked	Approved	Authorised
1:250	ZM	PB	JH	ET

Original Size	Date	Date	Date	Date
A1	03/07/24	03/07/24	03/07/24	03/07/24

Drawing Number	Project	Originator	Volume	Job No.
TO-12 DR	-ATK	HKF	BH23_FW018	5221621

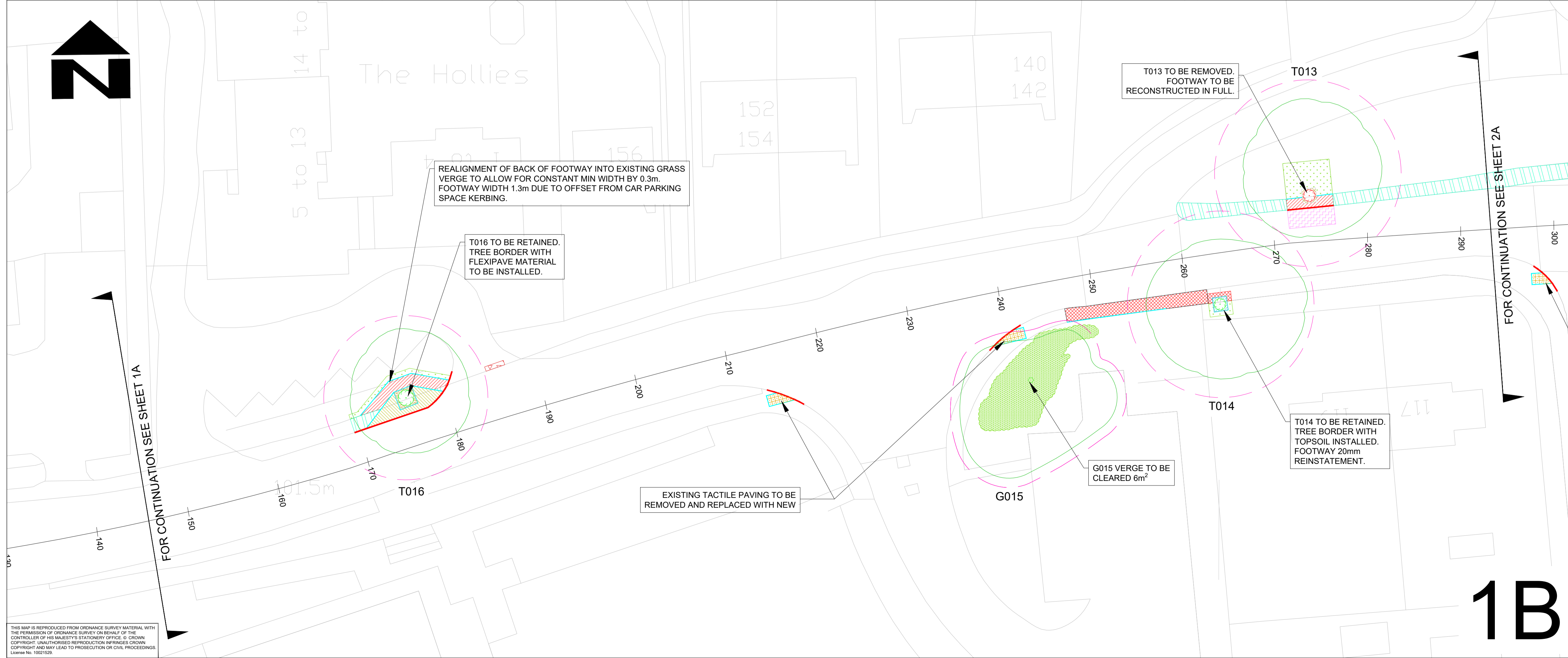

THIS MAP IS REPRODUCED FROM ORDNANCE SURVEY MATERIAL WITH THE PERMISSION OF ORDNANCE SURVEY ON BEHALF OF THE CONTROLLER OF HIS MAJESTY'S STATIONERY OFFICE. © CROWN COPYRIGHT. UNAUTHORISED REPRODUCTION INFRINGES CROWN COPYRIGHT AND MAY LEAD TO PROSECUTION OR CIVIL PROCEEDINGS. License No. 10021529

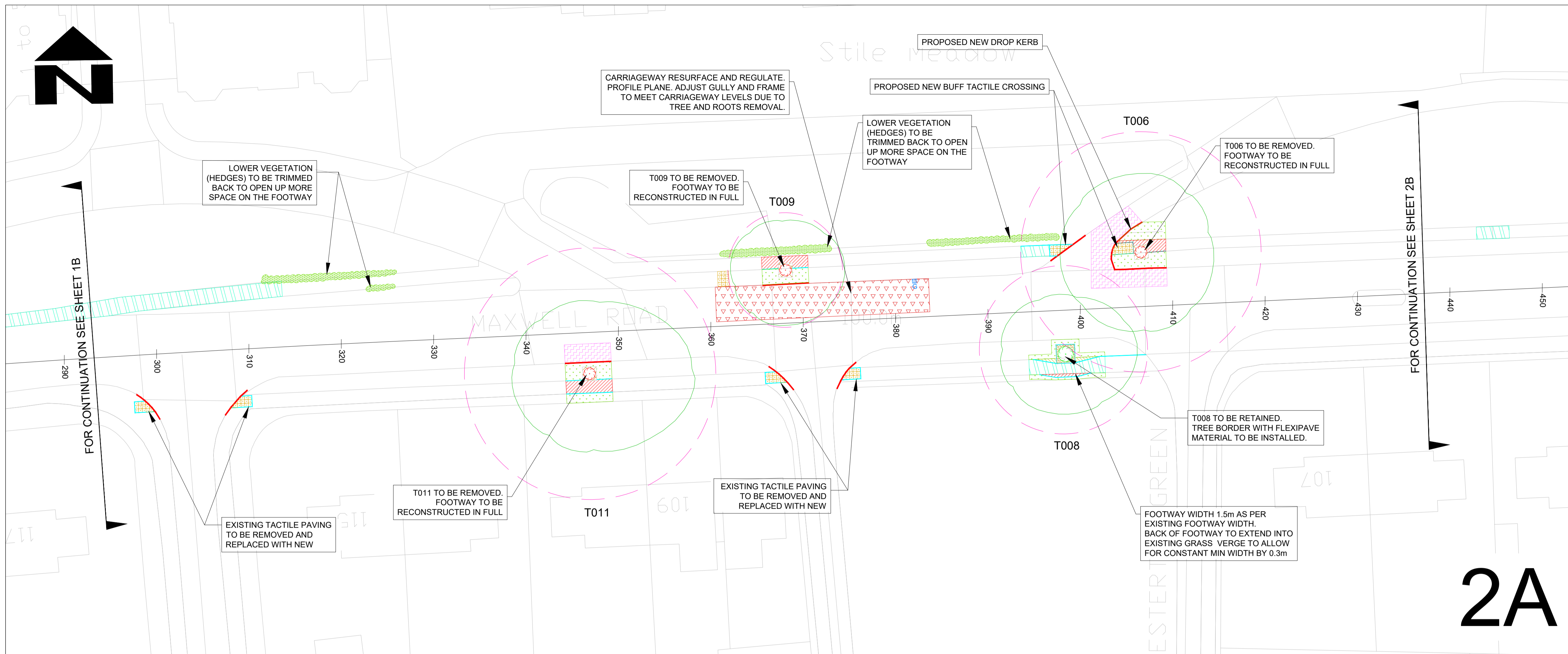

# 2A

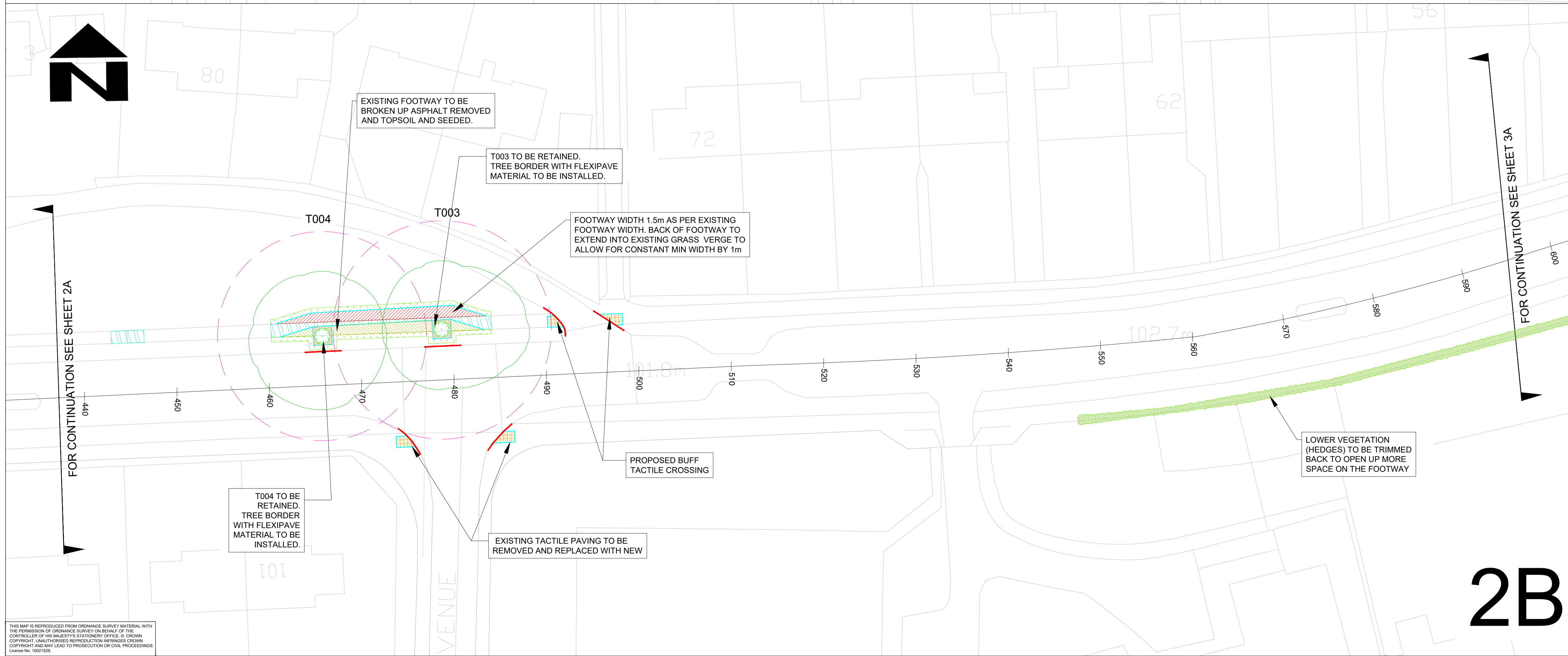

# 2B

- NOTES:**
- DO NOT SCALE FROM THIS DRAWING
  - ALL DIMENSIONS ARE IN METRES UNLESS STATED.
  - TOTAL AREAS ARE NOTES IN KEY
  - THERE IS NO TOPOGRAPHICAL DATA FOR THIS SCHEME. ALL INFORMATION IS BASED ON OS DATA AS WELL AS THE WT8 SURVEY CARRIED OUT NOVEMBER 2023.
  - ALL WORKS ARE TO BE CARRIED OUT AND CONSTRUCTED AS PER BUCKINGHAMSHIRE COUNCIL SPECIFICATIONS UNLESS STATED OTHERWISE
- KEY:**
- 20mm FOOTWAY REINSTATEMENT = 25m<sup>2</sup>
  - 70mm FOOTWAY REINSTATEMENT = 121m<sup>2</sup>
  - 170mm FOOTWAY FULL CONSTRUCTION = 70m<sup>2</sup>
  - BREAK UP ASPHALT AND TAKE TO TIP, TOPSOIL AND SEED = 14m<sup>2</sup>
  - 150mm TOPSOIL AND SEED = 115m<sup>2</sup>
  - FLEXIPAVE MATERIAL = 11m<sup>2</sup>
  - POSSIBLE FULL CARRIAGEWAY CONSTRUCTION = 65m<sup>2</sup> @850mm DEPTH
  - TREE AND ROOT SYSTEM REMOVAL
  - 150mm TOPSOIL = 7m<sup>2</sup>
  - 40mm THSC AND REGULATING COURSE = 151m<sup>2</sup>
  - RESET BLOCK WORK, 25mm SAND BED = 62m<sup>2</sup>
  - KERB
  - EDGING KERB
  - TACTILE PAVING WITH 25mm SAND BED AND TYPE 1 SUB-BASE MATERIAL = 34m<sup>2</sup>
  - NEW STEEL BOLLARD
  - ADJUST AND RE-SEAT STEEL BOLLARD
  - LIGHTING COLUMN
  - HEDGE TRIM / VEG CLEARANCE
  - DROP KERB
  - ROOT PROTECTION AREA (RPA)
  - TREE CANOPY
  - TREE TO RETAIN
  - TREE TO REMOVE

**SAFETY, HEALTH AND ENVIRONMENTAL INFORMATION**

In addition to the hazards/risks normally associated with the types of work detailed on this drawing, note the following significant residual risks (Reference shall also be made to the design hazard log).

Construction	Live traffic.
Maintenance / Cleaning	None.

Use	Low long-term risk of trees and roots potentially causing obstruction and/or damage to the footway and surrounding areas.
-----	---

Decommissioning / Demolition	None
------------------------------	------

Rev	Drawn / Des	Checked	Approved	Date
P01	ZM	GC	GC	08/05/24
P02	ZM	PB	JH	03/07/24

Rev	Drawn / Des	Checked	Approved	Date
P01	ZM	GC	GC	08/05/24
P02	ZM	PB	JH	03/07/24

Drawing Status	FOR REVIEW / COMMENT	Suitability	S3
----------------	----------------------	-------------	----

**AtkinsRéalis** | Walton Street Office, Walton Street, Aylesbury, Buckinghamshire, HP20 1UA GB, www.atkinsglobal.com

Copyright © AtkinsRéalis (2023)

Client: **Buckinghamshire Highways** | Kevin Good, Service Director, Highways & Technical Services

Project Title: **5221621 Footway Structural Repairs Maintenance**

Drawing Title: **BH23FW018 MAXWELL ROAD, BEACONSFIELD OPTION 3**

Scale	1:250	Designed / Drawn	ZM	Checked	PB	Approved	JH	Authorised	ET
Original Size	A1	Date	03/07/24	Date	03/07/24	Date	03/07/24	Date	03/07/24
Drawing Number	TO-12	Project	-ATK	Originator	HKF	Volume	BH23_FW018	Job No.	5221621
	DR		-CH-				-000003	Revision	P02
		Location		Type		Role		Number	

THIS MAP IS REPRODUCED FROM ORDNANCE SURVEY MATERIAL WITH THE PERMISSION OF ORDNANCE SURVEY ON BEHALF OF THE CONTROLLER OF HIS MAJESTY'S STATIONERY OFFICE. © CROWN COPYRIGHT. UNAUTHORISED REPRODUCTION INFRINGES CROWN COPYRIGHT AND MAY LEAD TO PROSECUTION OR CIVIL PROCEEDINGS. License No. 10021029

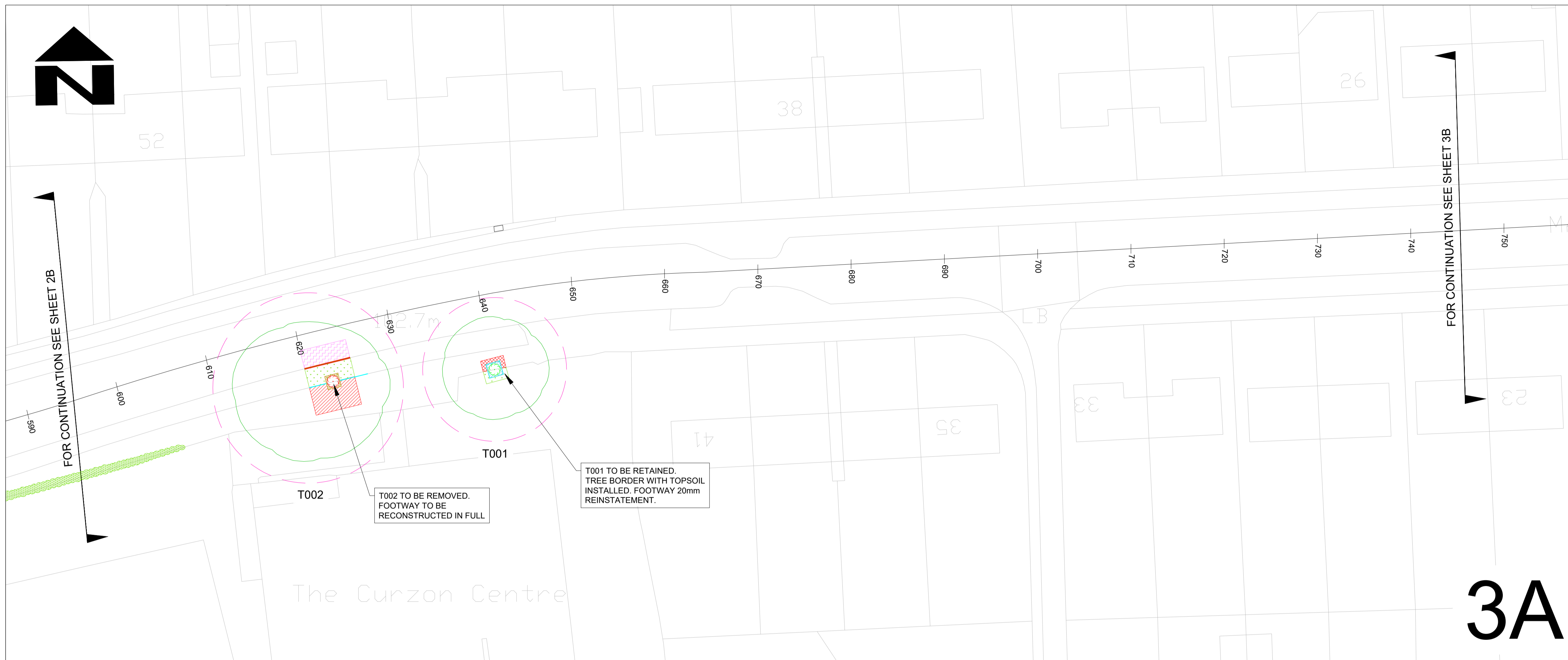

# 3A

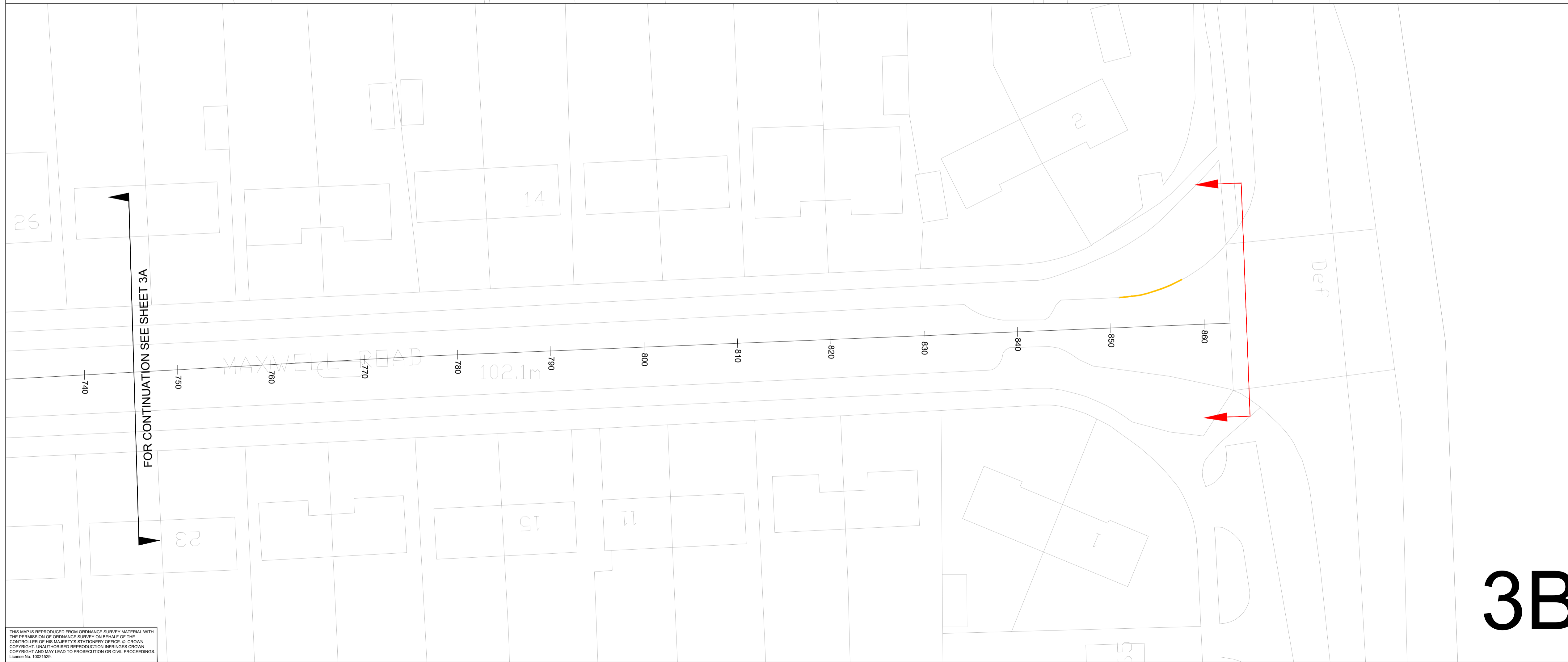

# 3B

- NOTES:**
- DO NOT SCALE FROM THIS DRAWING
  - ALL DIMENSIONS ARE IN METRES UNLESS STATED.
  - TOTAL AREAS ARE NOTES IN KEY.
  - THERE IS NO TOPOGRAPHICAL DATA FOR THIS SCHEME. ALL INFORMATION IS BASED ON OS DATA AS WELL AS THE WTB SURVEY CARRIED OUT NOVEMBER 2023.
  - ALL WORKS ARE TO BE CARRIED OUT AND CONSTRUCTED AS PER BUCKINGHAMSHIRE COUNCIL SPECIFICATIONS UNLESS STATED OTHERWISE
- KEY:**
- 20mm FOOTWAY REINSTATEMENT = 25m<sup>2</sup>
  - 70mm FOOTWAY REINSTATEMENT = 121m<sup>2</sup>
  - 170mm FOOTWAY FULL CONSTRUCTION = 70m<sup>2</sup>
  - BREAK UP ASPHALT AND TAKE TO TIP, TOPSOIL AND SEED = 14m<sup>2</sup>
  - 150mm TOPSOIL AND SEED = 115m<sup>2</sup>
  - FLEXIPAVE MATERIAL = 11m<sup>2</sup>
  - POSSIBLE FULL CARRIAGEWAY CONSTRUCTION = 65m<sup>2</sup> @950mm DEPTH
  - TREE AND ROOT SYSTEM REMOVAL
  - 150mm TOPSOIL = 7m<sup>2</sup>
  - 40mm THSC AND REGULATING COURSE = 151m<sup>2</sup>
  - RESET BLOCK WORK, 25mm SAND BED = 62m<sup>2</sup>
  - KERB
  - EDGING KERB
  - TACTILE PAVING WITH 25mm SAND BED AND TYPE 1 SUB-BASE MATERIAL = 34m<sup>2</sup>
  - NEW STEEL BOLLARD
  - ADJUST AND RE-SEAT STEEL BOLLARD
  - LIGHTING COLUMN
  - HEDGE TRIM / VEG CLEARANCE
  - DROP KERB
  - ROOT PROTECTION AREA (RPA)
  - TREE CANOPY
  - TREE TO RETAIN
  - TREE TO REMOVE

**SAFETY, HEALTH AND ENVIRONMENTAL INFORMATION**

In addition to the hazards/risks normally associated with the types of work detailed on this drawing, note the following significant residual risks (Reference shall also be made to the design hazard log).

**Construction**  
 Live traffic.  
 Presence of tar, presence of soil contamination, asbestos and breaking of concrete not known.  
 Underground services present throughout site works but unrecorded or unidentified utilities may still be present.

**Maintenance / Cleaning**  
 None.

**Use**  
 Low long-term risk of trees and roots potentially causing obstruction and/or damage to the footway and surrounding areas.

**Decommissioning / Demolition**  
 None

				08/05/24
P01	ZM	GC	GC	08/05/24

<b>First Issue</b>				
P02	ZM	PB	JH	03/07/24

<b>Rev</b>				
Drawn / Des	Checked	Approved	Date	

<b>Drawing Status</b>		<b>Suitability</b>
FOR REVIEW / COMMENT		S3

**AtkinsRéalis**  
 Walton Street Office,  
 Walton Street  
 Aylesbury  
 Buckinghamshire  
 HP20 1UA GB  
 www.atkinsglobal.com

Copyright © AtkinsRéalis (2023)

**Buckinghamshire Highways**  
 Kevin Good  
 Service Director  
 Highways & Technical Services

**Project Title**  
 5221621 Footway  
 Structural Repairs Maintenance

**Drawing Title**  
 BH23FW018  
 MAXWELL ROAD, BEACONSFIELD  
 OPTION 3

Scale	Designed / Drawn	Checked	Approved	Authorised
1:250	ZM	PB	JH	ET
Original Size	Date	Date	Date	Date
A1	03/07/24	03/07/24	03/07/24	03/07/24
Drawing Number	Project	Originator	Volume	Job No.
5221621	TO-12	-ATK	BH23 FW018	5221621
	DR	-CH-	-000003	P02
	Location	Type	Role	Number

THIS MAP IS REPRODUCED FROM ORDNANCE SURVEY MATERIAL WITH THE PERMISSION OF ORDNANCE SURVEY ON BEHALF OF THE CONTROLLER OF HIS MAJESTY'S STATIONERY OFFICE. © CROWN COPYRIGHT. UNAUTHORISED REPRODUCTION INFRINGES CROWN COPYRIGHT AND MAY LEAD TO PROSECUTION OR CIVIL PROCEEDINGS. License No. 10021529